



11 Farmborough Close
Harrow, HA1 3YG

£69,950



11 Farmborough Close

Harrow, HA1 3YG

Wilson Hawkins are delighted to present to the market this Two double bedroom, ground floor Retirement flat offering a 25% share in the ownership. The property benefits from a new kitchen & bathroom, gas central heating, laminated flooring, quality double glazing, own rear garden, resident and visitors parking, emergency intercom and pull cords in all rooms plus no upper chain.

Only available to persons over 60 years of age.

Farmborough Close is a popular retirement development and is situated approximately 2/3 mile from Harrow Town Centre with its excellent range of shopping facilities and transport links including the Metropolitan/Chiltern line station.

Own Front door

Entrance Hall

Lounge

Kitchen

Bathroom

Bedroom One

Bedroom Two

Bathroom

Outside

Own rear garden

Communal Gardens

Further Infomration





Lease- 95 Years remaining
Service Charge- £211 per month
Additional rent-£ 166.46 per month
Council Tax band- C



Floor Plan

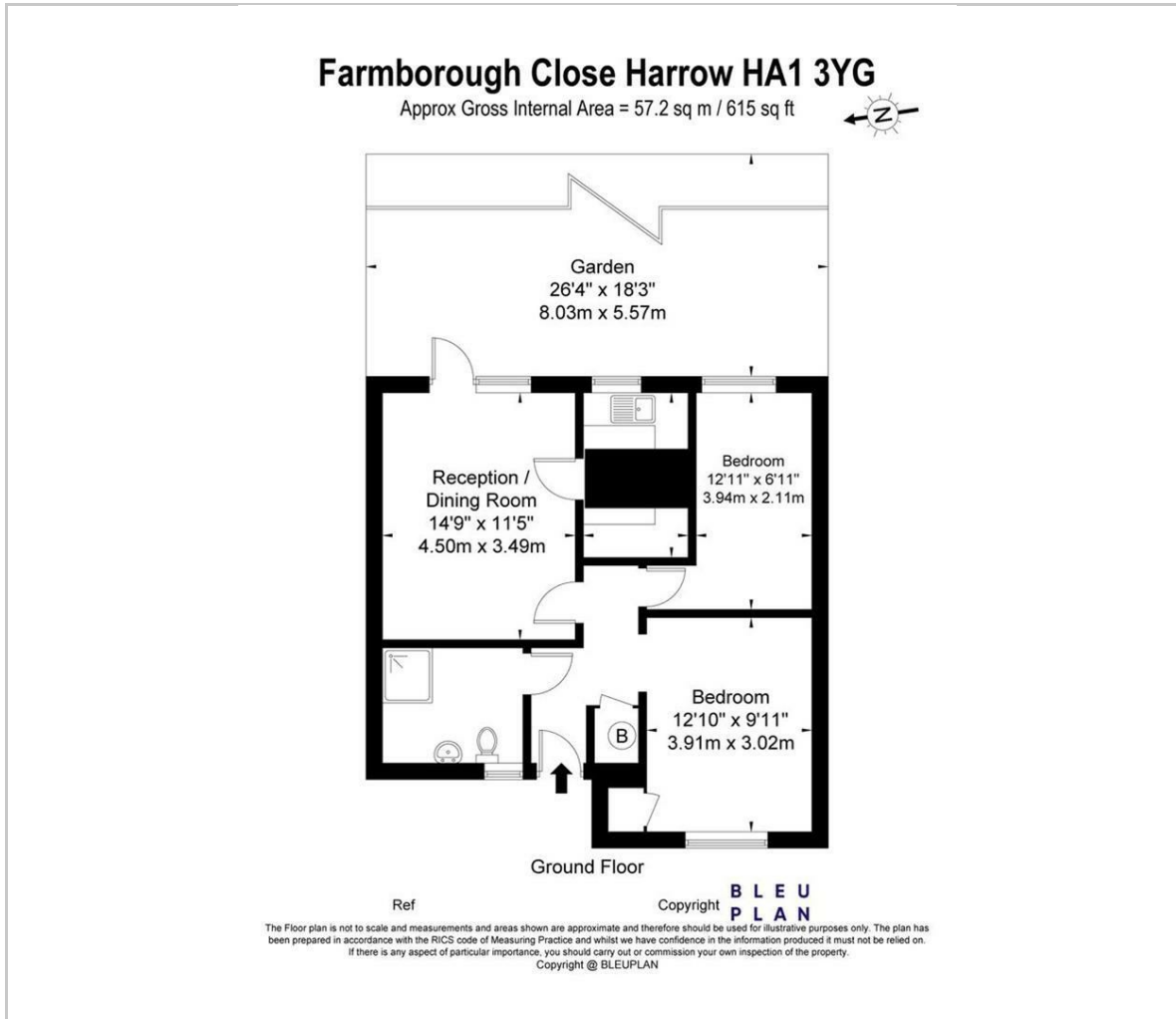

Viewing

Please contact our Harrow on the Hill Office on 020 8422 3333 if you wish to arrange a viewing appointment for this property or require further information.

Area Map

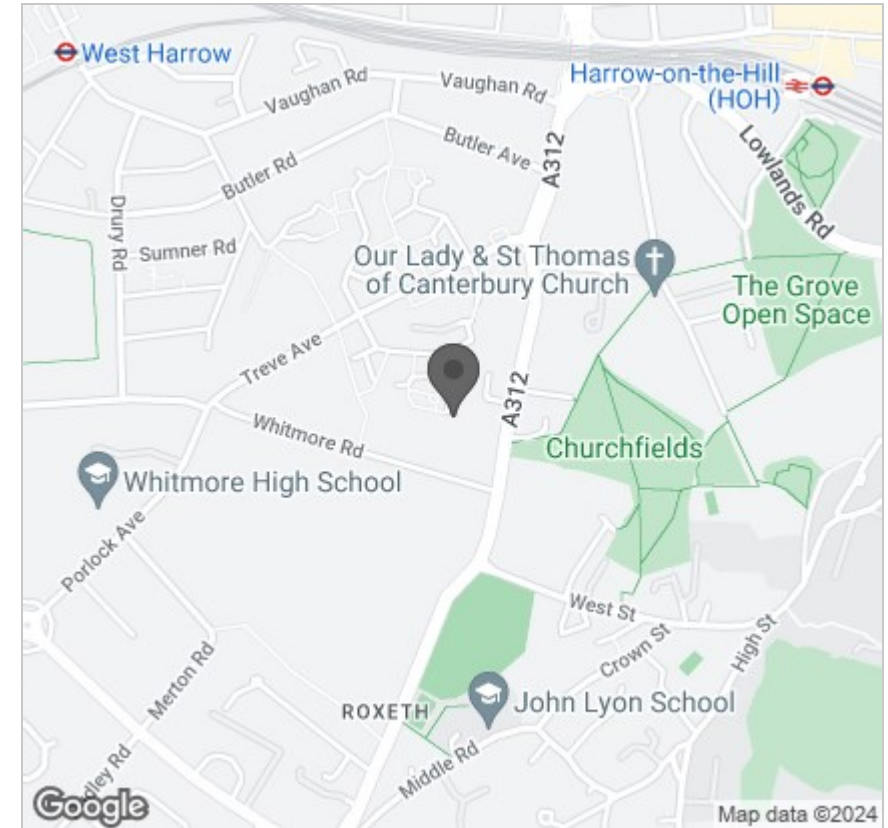

Energy Efficiency Graph

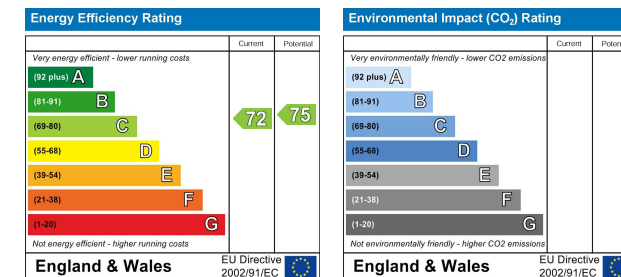

These particulars, whilst believed to be accurate are set out as a general outline only for guidance and do not constitute any part of an offer or contract. Intending purchasers should not rely on them as statements of representation of fact, but must satisfy themselves by inspection or otherwise as to their accuracy. No person in this firm's employment has the authority to make or give any representation or warranty in respect of the property.

33-35 High Street, Harrow On The Hill, Harrow, Middlesex, HA1 3HT
Tel: 020 8422 3333 Email: enquiries@wilson-hawkins.co.uk www.wilson-hawkins.co.uk