



28 Crown Street
Harrow On The Hill, HA2 0HR

£475,000

28 Crown Street

Harrow On The Hill, HA2 0HR

A Period Two Bedroom, Two Reception Room, End of Terrace Family Home arranged over three floors and well set on this sought after road within the village conservation area. The property enjoys panoramic views to the West over Church Fields and has retained many of its original period features and benefits from hardwood flooring, gas fired central heating & a spacious kitchen/diner. The property is well set amongst similar period properties near the summit of The Hill and is within easy walking distance of the historic buildings, wine bars and places of interest on The Hill.

The area is particularly well served for good schooling including Orley Farm Preparatory School, John Lyon, St Dominic's Sixth Form College and the renowned Harrow School. Harrow town centre is within 10 minutes walk with its Metropolitan/Chiltern Line station and excellent range of shopping facilities.

Front Door

Kitchen/Dining Room

Stairs to First Floor

Lounge

Bathroom

Stairs to Second Floor

Bedroom One

Bedroom Two

Rear Garden

Council Tax- Band D





Floor Plan

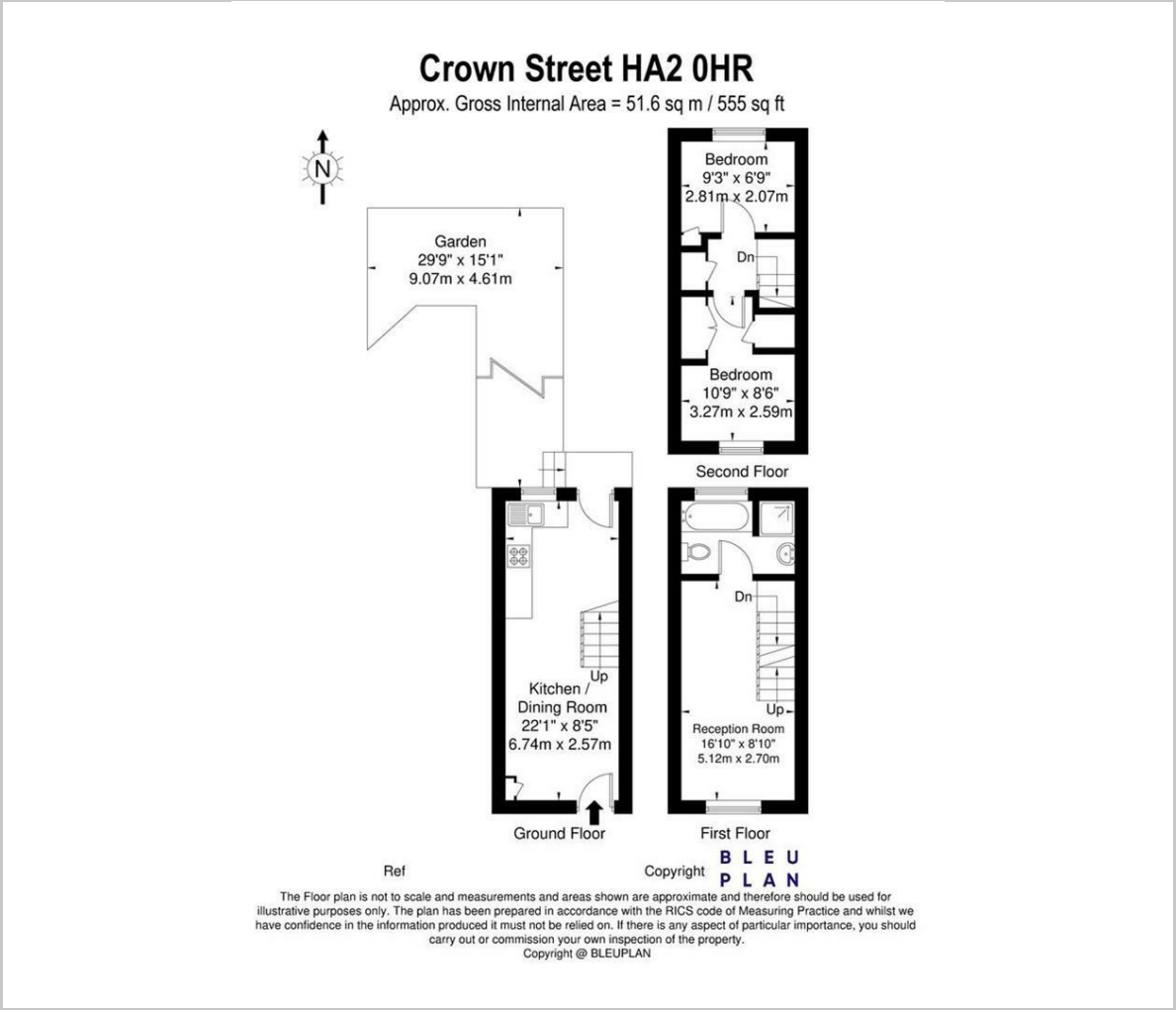

Viewing

Please contact our Harrow on the Hill Office on 020 8422 3333 if you wish to arrange a viewing appointment for this property or require further information.

Area Map



Energy Efficiency Graph

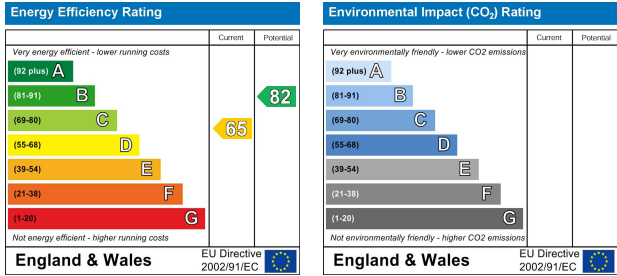

These particulars, whilst believed to be accurate are set out as a general outline only for guidance and do not constitute any part of an offer or contract. Intending purchasers should not rely on them as statements of representation of fact, but must satisfy themselves by inspection or otherwise as to their accuracy. No person in this firms employment has the authority to make or give any representation or warranty in respect of the property.

33-35 High Street, Harrow On The Hill, Harrow, Middlesex, HA1 3HT
Tel: 020 8422 3333 Email: enquiries@wilson-hawkins.co.uk www.wilson-hawkins.co.uk