



7 Betjeman Close

Pinner, HA5 5SA

£179,950



A Double Bedroom Ground Floor RETIREMENT Apartment conveniently situated in this sought after development in this quiet cul de sac. The accommodation comprises spacious lounge, good size kitchen with door to private patio and access to the communal gardens. Double glazing, emergency intercom and pull cords in each room. Part time Resident warden, communal laundry room, landscaped gardens and resident parking. Available to persons over the age of 60 only. No Upper Chain.



Communal Front Door

Own Front Door

Entrance Hall

Lounge

Kitchen

Door to private garden terrace.

Bedroom

Bathroom

Outside

Private Patio, Communal Gardens.

Resident Parking. Communal Laundry Room

Leasehold Information

Lease- New 99 year lease to be granted on completion

Service Charge - £170.97 Per month.

Ground Rent- £150 per annum

Council Tax Band C

Area Map

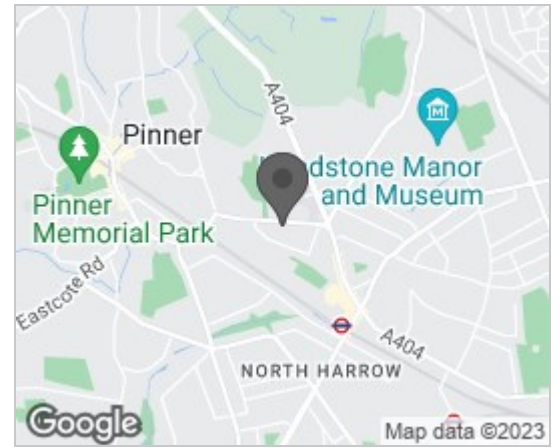

Floor Plans

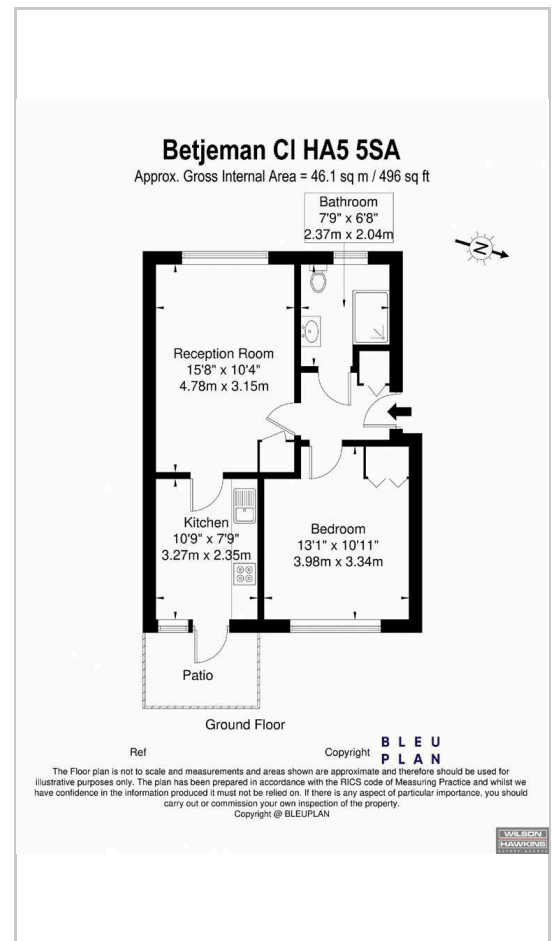

Energy Efficiency Graph

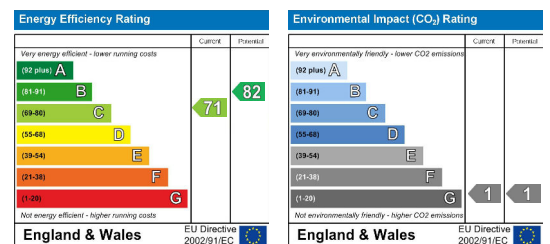

These particulars, whilst believed to be accurate are set out as a general outline only for guidance and do not constitute any part of an offer or contract. Intending purchasers should not rely on them as statements of representation of fact, but must satisfy themselves by inspection or otherwise as to their accuracy. No person in this firm's employment has the authority to make or give any representation or warranty in respect of the property.

33-35 High Street, Harrow On The Hill, Harrow, Middlesex, HA1 3HT

Tel: 020 8422 3333 Email: enquiries@wilson-hawkins.co.uk www.wilson-hawkins.co.uk